



## CANILO

SUSPENDED LUMINAIRE

CANILO is characterised by classic, elegant design and provides a special element for supporting the customer's CI: the lateral bracket can be adjusted colour-wise to customise it. The set-back reflector with an integrated anti-glare ring provides a high degree of visual comfort. The variable suspension that can be adjusted without tools and is in the form of a live wire imparts an elegant look to the suspended luminaire.



### Customised style

The lateral lug can be adapted colour-wise to customer's CI



### Uniform effect

The suspension and the lug specify the mounting direction and in the case of several luminaires ensure a calm overall appearance.



### Various fastening possibilities

As a means of fastening a ceiling canopy, a ceiling roundel or an adapter for attachment to power tracks are available



### High degree of visual comfort



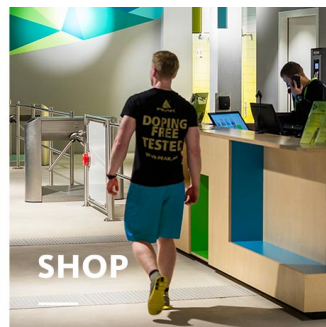
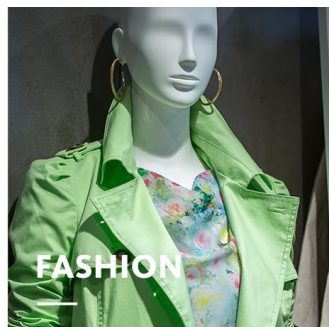



Set-back reflector ensures good glare suppression without any loss of light

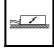

# CANILO

# oktalite

[www.oktalite.com/canilo-p](http://www.oktalite.com/canilo-p)

Type of luminaire	suspended luminaire
Application areas	Accent lighting
Pan/tilt range	fixed
Mounting	3P Power Track, recessed (Ø 130mm), Surface mounted (Ø 150mm)
Ceiling thickness	1 - 25 mm
Lighting technology	LED
LED Luminous Flux Class	2000 lm - 4000 lm
Light colour White	2700 K, 3000 K, 3000 K - Efficient White, 3000 K - Brilliant Colour, 3500 K, 4000 K
Cooling	passive
Supply unit	Driver separate / integrated
Luminaire colour	RAL 9005 jet black RAL 9006 white aluminium RAL 9016 traffic white Special colours on request
Surface	structure powder-coated
Suspension length	1500mm, 3000mm
Nominal voltage	220 - 240 V, 50/60Hz
Lighting controls	on request
Weight	Approx. 2.0 kg
Components	 Luminaire housing  Optic  Supply unit
Test seal	   

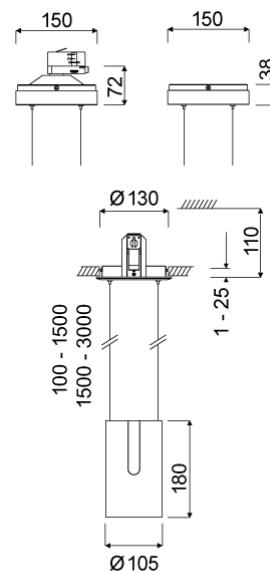

Technical details as well as weight specifications and measurements have been prepared with care. Errors excepted. All dimensions in mm · LED service life data: L80/B10 at ambient temperature (ta) 25°C. Rated lamp service life 50,000h. Luminous flux and efficiency specifications are subject to a tolerance of +/- 10%. Min CRI Ra: >80 / >90 · Product images are used as an example and may differ from the original · We reserve the right to make changes, insofar as they serve progress. Oktalite Lichttechnik GmbH · Mathias-Brüggen-Str. 73 · 50829 Cologne · T +49 221 59767-0 · F +49 221 59767-40 · mail@oktalite.com · www.oktalite.com · 2021-01-24

**CANILO****oktalite**Mounting  
Supply unitSurface mounted (Ø 150mm)  
integrated

LED Luminous Flux Class	Light colour	CRI R <sub>a</sub>	system luminous flux*	System performance	Suspension length	Order number		
						white	silver	black
2000 lm	3000 K - Efficient White	94	1910 lm	18 W	1500mm	10226671	10226672	10226673
2000 lm	3000 K - Efficient White	94	1910 lm	18 W	3000mm	10226674	10226675	10226676
2000 lm	3000 K - Brilliant Colour	97	1800 lm	22 W	1500mm	10226677	10226678	10226679
2000 lm	3000 K - Brilliant Colour	97	1800 lm	22 W	3000mm	10226680	10226681	10226682
3000 lm	2700 K	81	2710 lm	24 W	1500mm	10226683	10226684	10226685
3000 lm	2700 K	81	2710 lm	24 W	3000mm	10226686	10226687	10226688
3000 lm	3000 K	83	2825 lm	24 W	1500mm	10226689	10226690	10226691
3000 lm	3000 K	83	2825 lm	24 W	3000mm	10226692	10226693	10226694
3000 lm	3000 K - Efficient White	94	2785 lm	29 W	1500mm	10226695	10226696	10226697
3000 lm	3000 K - Efficient White	94	2785 lm	29 W	3000mm	10226698	10226699	10226700
3000 lm	3000 K - Brilliant Colour	97	2700 lm	37 W	1500mm	10226701	10226702	10226703
3000 lm	3000 K - Brilliant Colour	97	2700 lm	37 W	3000mm	10226704	10226705	10226706
3000 lm	3500 K	84	2880 lm	24 W	1500mm	10226707	10226708	10226709
3000 lm	3500 K	84	2880 lm	24 W	3000mm	10226710	10226711	10226712
3000 lm	4000 K	83	2935 lm	24 W	1500mm	10226713	10226714	10226715
3000 lm	4000 K	83	2935 lm	24 W	3000mm	10226716	10226717	10226718

Technical details as well as weight specifications and measurements have been prepared with care. Errors excepted. All dimensions in mm · LED service life data: L80/B10 at ambient temperature (ta) 25°C. Rated lamp service life 50,000h. Luminous flux and efficiency specifications are subject to a tolerance of +/- 10%. Min CRI Ra: >80 / >90 · Product images are used as an example and may differ from the original · We reserve the right to make changes, insofar as they serve progress. Oktalite Lichttechnik GmbH · Mathias-Brüggen-Str. 73 · 50829 Cologne · T +49 221 59767-0 · F +49 221 59767-40 · mail@oktalite.com · www.oktalite.com · 2021-01-24



Luminaire housing - LED

# CANILO

# oktalite

Mounting  
Supply unit

3P Power Track  
integrated

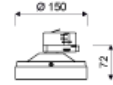

LED Luminous Flux Class	Light colour	CRI R <sub>a</sub>	system luminous flux*	System performance	Suspension length	Order number		
						white	silver	black
2000 lm	3000 K - Efficient White	94	1910 lm	18 W	1500mm	10226623	10226624	10226625
2000 lm	3000 K - Efficient White	94	1910 lm	18 W	3000mm	10226626	10226627	10226628
2000 lm	3000 K - Brilliant Colour	97	1800 lm	22 W	1500mm	10226629	10226630	10226631
2000 lm	3000 K - Brilliant Colour	97	1800 lm	22 W	3000mm	10226632	10226633	10226634
3000 lm	2700 K	81	2710 lm	24 W	1500mm	10226635	10226636	10226637
3000 lm	2700 K	81	2710 lm	24 W	3000mm	10226638	10226639	10226640
3000 lm	3000 K	83	2825 lm	24 W	1500mm	10226641	10226642	10226643
3000 lm	3000 K	83	2825 lm	24 W	3000mm	10226644	10226645	10226646
3000 lm	3000 K - Efficient White	94	2785 lm	29 W	1500mm	10226647	10226648	10226649
3000 lm	3000 K - Efficient White	94	2785 lm	29 W	3000mm	10226650	10226651	10226652
3000 lm	3000 K - Brilliant Colour	97	2700 lm	37 W	1500mm	10226653	10226654	10226655
3000 lm	3000 K - Brilliant Colour	97	2700 lm	37 W	3000mm	10226656	10226657	10226658
3000 lm	3500 K	84	2880 lm	24 W	1500mm	10226659	10226660	10226661
3000 lm	3500 K	84	2880 lm	24 W	3000mm	10226662	10226663	10226664
3000 lm	4000 K	83	2935 lm	24 W	1500mm	10226665	10226666	10226667
3000 lm	4000 K	83	2935 lm	24 W	3000mm	10226668	10226669	10226670

Technical details as well as weight specifications and measurements have been prepared with care. Errors excepted. All dimensions in mm · LED service life data: L80/B10 at ambient temperature (ta) 25°C. Rated lamp service life 50,000h. Luminous flux and efficiency specifications are subject to a tolerance of +/- 10%. Min CRI Ra: >80 / >90 · Product images are used as an example and may differ from the original · We reserve the right to make changes, insofar as they serve progress. Oktalite Lichttechnik GmbH · Mathias-Brüggen-Str. 73 · 50829 Cologne · T +49 221 59767-0 · F +49 221 59767-40 · mail@oktalite.com · www.oktalite.com · 2021-01-24



Luminaire housing - LED

# CANILO

# oktalite

Mounting recessed (Ø 130mm)  
Supply unit separate

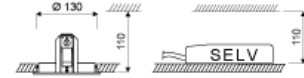

LED Luminous Flux Class	Light colour	CRI R <sub>a</sub>	system luminous flux*	System performance	Suspension length	Order number		
						white	silver	black
2000 lm	3000 K - Efficient White	94	1910 lm	18 W	1500mm	10226737	10226738	10226739
2000 lm	3000 K - Efficient White	94	1910 lm	18 W	3000mm	10226740	10226741	10226742
2000 lm	3000 K - Brilliant Colour	97	1800 lm	22 W	1500mm	10226719	10226720	10226721
2000 lm	3000 K - Brilliant Colour	97	1800 lm	22 W	3000mm	10226722	10226723	10226724
3000 lm	2700 K	81	2710 lm	24 W	1500mm	10226725	10226726	10226727
3000 lm	2700 K	81	2710 lm	24 W	3000mm	10226728	10226729	10226730
3000 lm	3000 K	83	2825 lm	24 W	1500mm	10226731	10226732	10226733
3000 lm	3000 K	83	2825 lm	24 W	3000mm	10226734	10226735	10226736
3000 lm	3000 K - Efficient White	94	2785 lm	29 W	1500mm	10226737	10226738	10226739
3000 lm	3000 K - Efficient White	94	2785 lm	29 W	3000mm	10226740	10226741	10226742
3000 lm	3000 K - Brilliant Colour	97	2700 lm	37 W	1500mm	10226719	10226720	10226721
3000 lm	3000 K - Brilliant Colour	97	2700 lm	37 W	3000mm	10226722	10226723	10226724
3000 lm	3500 K	84	2880 lm	24 W	1500mm	10226743	10226744	10226745
3000 lm	3500 K	84	2880 lm	24 W	3000mm	10226746	10226747	10226748
3000 lm	4000 K	83	2935 lm	24 W	1500mm	10226749	10226750	10226751
3000 lm	4000 K	83	2935 lm	24 W	3000mm	10226752	10226753	10226754

Technical details as well as weight specifications and measurements have been prepared with care. Errors excepted. All dimensions in mm · LED service life data: L80/B10 at ambient temperature (ta) 25°C. Rated lamp service life 50,000h. Luminous flux and efficiency specifications are subject to a tolerance of +/- 10%. Min CRI Ra: >80 / >90 · Product images are used as an example and may differ from the original · We reserve the right to make changes, insofar as they serve progress. Oktalite Lichttechnik GmbH · Mathias-Brüggen-Str. 73 · 50829 Cologne · T +49 221 59767-0 · F +49 221 59767-40 · mail@oktalite.com · www.oktalite.com · 2021-01-24

\* System luminous flux based on medium flood reflector.



Efficient White:  $R_9 = 75$ ,  $R_i = 91$ ,  $R_g = 102$



Brilliant Colour:  $R_9 = 94$ ,  $R_i = 95$ ,  $R_g = 104$

Technical details as well as weight specifications and measurements have been prepared with care. Errors excepted. All dimensions in mm · LED service life data: L80/B10 at ambient temperature ( $t_a$ ) 25°C. Rated lamp service life 50,000h. Luminous flux and efficiency specifications are subject to a tolerance of +/- 10%. Min CRI Ra: >80 / >90 · Product images are used as an example and may differ from the original · We reserve the right to make changes, insofar as they serve progress. Oktalite Lichttechnik GmbH · Mathias-Brüggen-Str. 73 · 50829 Cologne · T +49 221 59767-0 · F +49 221 59767-40 · mail@oktalite.com · www.oktalite.com · 2021-01-24

# Optic 85 - LED

# oktalite

Optic 3D faceted reflectors  
 Type interchangeable reflector system

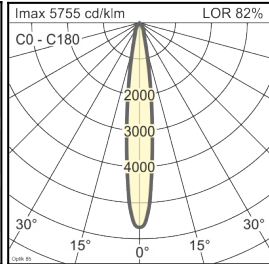
Beam angle				Cover	LOR	Order number																							
Spot						white	silver	black																					
<b>Optik 85 - SP</b> <table border="1"> <thead> <tr> <th>Höhe [m]</th> <th>KegelØ [cm]</th> <th>E(0°) [lx/klm]</th> <th>E(C0) [lx/klm]</th> </tr> </thead> <tbody> <tr> <td>1</td> <td>26</td> <td>5755</td> <td>2841</td> </tr> <tr> <td>2</td> <td>52</td> <td>1439</td> <td>710</td> </tr> <tr> <td>3</td> <td>78</td> <td>639</td> <td>316</td> </tr> </tbody> </table>				Höhe [m]	KegelØ [cm]	E(0°) [lx/klm]	E(C0) [lx/klm]	1	26	5755	2841	2	52	1439	710	3	78	639	316						without	82 %	-	-	10183944
Höhe [m]	KegelØ [cm]	E(0°) [lx/klm]	E(C0) [lx/klm]																										
1	26	5755	2841																										
2	52	1439	710																										
3	78	639	316																										
				clear	78 %	-	-		10184576																				

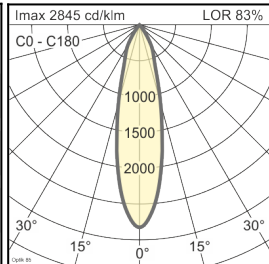
Beam angle				Cover	LOR	Order number																							
Medium Flood						white	silver	black																					
<b>Optik 85 - MF</b> <table border="1"> <thead> <tr> <th>Höhe [m]</th> <th>KegelØ [cm]</th> <th>E(0°) [lx/klm]</th> <th>E(C0) [lx/klm]</th> </tr> </thead> <tbody> <tr> <td>1</td> <td>45</td> <td>2845</td> <td>1321</td> </tr> <tr> <td>2</td> <td>91</td> <td>711</td> <td>330</td> </tr> <tr> <td>3</td> <td>136</td> <td>316</td> <td>147</td> </tr> </tbody> </table>				Höhe [m]	KegelØ [cm]	E(0°) [lx/klm]	E(C0) [lx/klm]	1	45	2845	1321	2	91	711	330	3	136	316	147						without	83 %	-	-	10183959
Höhe [m]	KegelØ [cm]	E(0°) [lx/klm]	E(C0) [lx/klm]																										
1	45	2845	1321																										
2	91	711	330																										
3	136	316	147																										
				clear	79 %	-	-		10184577																				

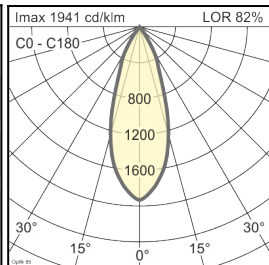
Beam angle				Cover	LOR	Order number																							
Flood						white	silver	black																					
<b>Optik 85 - FL</b> <table border="1"> <thead> <tr> <th>Höhe [m]</th> <th>KegelØ [cm]</th> <th>E(0°) [lx/klm]</th> <th>E(C0) [lx/klm]</th> </tr> </thead> <tbody> <tr> <td>1</td> <td>66</td> <td>1941</td> <td>832</td> </tr> <tr> <td>2</td> <td>132</td> <td>485</td> <td>208</td> </tr> <tr> <td>3</td> <td>197</td> <td>216</td> <td>92</td> </tr> </tbody> </table>				Höhe [m]	KegelØ [cm]	E(0°) [lx/klm]	E(C0) [lx/klm]	1	66	1941	832	2	132	485	208	3	197	216	92						without	82 %	-	-	10183953
Höhe [m]	KegelØ [cm]	E(0°) [lx/klm]	E(C0) [lx/klm]																										
1	66	1941	832																										
2	132	485	208																										
3	197	216	92																										
				clear	78 %	-	-		10184578																				

Technical details as well as weight specifications and measurements have been prepared with care. Errors excepted. All dimensions in mm · LED service life data: L80/B10 at ambient temperature (ta) 25°C. Rated lamp service life 50,000h. Luminous flux and efficiency specifications are subject to a tolerance of +/- 10%. Min CRI Ra: >80 / >90 · Product images are used as an example and may differ from the original · We reserve the right to make changes, insofar as they serve progress. Oktalite Lichttechnik GmbH · Mathias-Brüggen-Str. 73 · 50829 Cologne · T +49 221 59767-0 · F +49 221 59767-40 · mail@oktalite.com · www.oktalite.com · 2021-01-24

# Optic 85 - LED

# oktalite

Optic 3D faceted reflectors  
 Type interchangeable reflector system

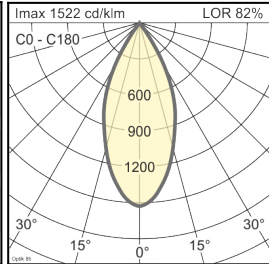
Beam angle				Cover	LOR	Order number																							
Wide Flood						white	silver	black																					
<b>Optik 85 - WFL</b> <table border="1"> <thead> <tr> <th>Höhe [m]</th> <th>KegelØ [cm]</th> <th>E(0°) [lx/klm]</th> <th>E(C0) [lx/klm]</th> </tr> </thead> <tbody> <tr> <td>1</td> <td>83</td> <td>1522</td> <td>601</td> </tr> <tr> <td>2</td> <td>167</td> <td>381</td> <td>150</td> </tr> <tr> <td>3</td> <td>250</td> <td>169</td> <td>67</td> </tr> </tbody> </table>				Höhe [m]	KegelØ [cm]	E(0°) [lx/klm]	E(C0) [lx/klm]	1	83	1522	601	2	167	381	150	3	250	169	67						without	82 %	-	-	10183954
Höhe [m]	KegelØ [cm]	E(0°) [lx/klm]	E(C0) [lx/klm]																										
1	83	1522	601																										
2	167	381	150																										
3	250	169	67																										
				clear	78 %	-	-	10184579																					

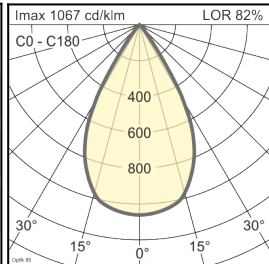
Beam angle				Cover	LOR	Order number																							
Very Wide Flood						white	silver	black																					
<b>Optik 85 - VFL</b> <table border="1"> <thead> <tr> <th>Höhe [m]</th> <th>KegelØ [cm]</th> <th>E(0°) [lx/klm]</th> <th>E(C0) [lx/klm]</th> </tr> </thead> <tbody> <tr> <td>1</td> <td>111</td> <td>1067</td> <td>360</td> </tr> <tr> <td>2</td> <td>223</td> <td>267</td> <td>90</td> </tr> <tr> <td>3</td> <td>334</td> <td>119</td> <td>40</td> </tr> </tbody> </table>				Höhe [m]	KegelØ [cm]	E(0°) [lx/klm]	E(C0) [lx/klm]	1	111	1067	360	2	223	267	90	3	334	119	40						without	82 %	-	-	10183955
Höhe [m]	KegelØ [cm]	E(0°) [lx/klm]	E(C0) [lx/klm]																										
1	111	1067	360																										
2	223	267	90																										
3	334	119	40																										
				clear	78 %	-	-	10184580																					

Technical details as well as weight specifications and measurements have been prepared with care. Errors excepted. All dimensions in mm · LED service life data: L80/B10 at ambient temperature (ta) 25°C. Rated lamp service life 50,000h. Luminous flux and efficiency specifications are subject to a tolerance of +/- 10%. Min CRI Ra: >80 / >90 · Product images are used as an example and may differ from the original · We reserve the right to make changes, insofar as they serve progress. Oktalite Lichttechnik GmbH · Mathias-Brüggen-Str. 73 · 50829 Cologne · T +49 221 59767-0 · F +49 221 59767-40 · mail@oktalite.com · www.oktalite.com · 2021-01-24





Supply unit - LED

## Driver

# oktalite

Connection type	Pre-wired plug-in connectivity
Mains connection	GST 18i3
Cable length secondary	400 mm
Nominal voltage	220 - 240 V, 50/60Hz
protection	IP20
protection class	I, II
Lighting controls	on request
Lighting technology	LED

Lighting technology	Luminaire connection	Output	System performance	max. luminaires B16	Order number
LED	RNV	450 mA	18 W	49	10211947
LED	RNV	550 mA	22 W	25	10211949
LED	RNV	600 mA	24 W	25	10211950
LED	RNV	700 mA	29 W	25	10211952
LED	RNV	900 mA	37 W	25	10211956

Technical details as well as weight specifications and measurements have been prepared with care. Errors excepted. All dimensions in mm · LED service life data: L80/B10 at ambient temperature (ta) 25°C. Rated lamp service life 50,000h. Luminous flux and efficiency specifications are subject to a tolerance of +/- 10%. Min CRI Ra: >80 / >90 · Product images are used as an example and may differ from the original · We reserve the right to make changes, insofar as they serve progress. Oktalite Lichttechnik GmbH · Mathias-Brüggen-Str. 73 · 50829 Cologne · T +49 221 59767-0 · F +49 221 59767-40 · mail@oktalite.com · www.oktalite.com · 2021-01-24