



B.VEO TRACK

TRACK LIGHT

With B.VEO TRACK the product family is complete. What is special about this single spotlight variant is its extremely narrow housing that visually almost fuses with the power track. In that way a very uncluttered pattern of the ceiling lighting is obtained. This becomes possible through the integration of the driver into the adapter.



Subdued look

Uncluttered ceiling pattern due to extremely flat housing, spotlight with pinpoint accuracy.



Economical mounting

Fast, tool-free, inexpensive due to use of existing 3-current power tracks



Flexible illumination

Accents set easily: spotlight head turning through 355° and tilting through 90°



Strong directional spotlight

Maximum power by up to 4000 lumens in the mini spotlight



Intelligent light

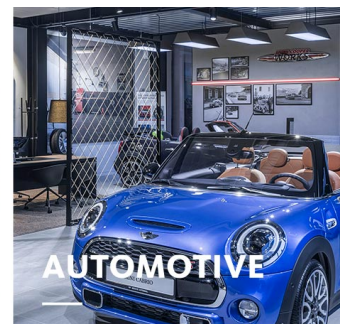
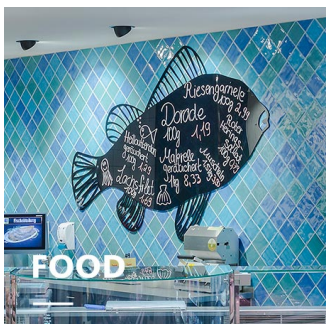

Smart lighting management optionally with control line or wireless



B.VEO TRACK

oktalite

www.oktalite.com/bveo-track-t

Type of luminaire	track light
Application areas	Accent lighting
Pan/tilt range	355° turning range, 90° swivel range
Mounting	3P Power Track, not suitable for vertical mounting
Lighting technology	LED
LED Luminous Flux Class	2000 lm - 4000 lm
Light colour White	2700 K, 3000 K, 3000 K - Efficient White, 3000 K - Brilliant Colour, 3500 K, 4000 K, 4000 K - Efficient Cool
Light colour Food*	BF
Cooling	passive
Supply unit	Driver integrated
Luminaire colour	RAL 9005 jet black RAL 9006 white aluminium RAL 9016 traffic white Special colours on request
Surface	structure powder-coated
Nominal voltage	220 - 240 V, 50/60Hz
Lighting controls	on request
Weight	Approx. 0.8 kg
Components	 Luminaire housing  Optic
Test seal	   

* BF = Brilliant Food

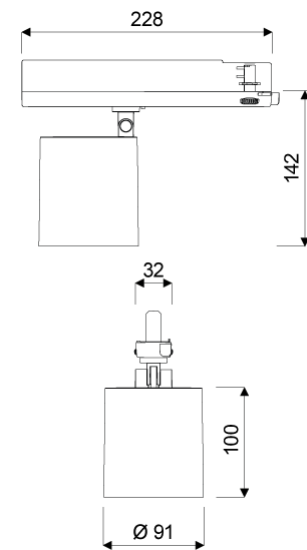

Technical details as well as weight specifications and measurements have been prepared with care. Errors excepted. All dimensions in mm · LED service life data: L80/B10 at ambient temperature (ta) 25°C. Rated lamp service life 50,000h. Luminous flux and efficiency specifications are subject to a tolerance of /- 10%. Min CRI Ra: >80 / >90· Product images are used as an example and may differ from the original · We reserve the right to make changes, insofar as they serve progress. The Single Lighting Regulation (SLR) documentation can be found in our download area. Oktalite Lichttechnik GmbH · Mathias-Brüggen-Str. 73 · 50829 Cologne · T 49 221 59767-0 · F 49 221 59767-40 · mail@oktalite.com · www.oktalite.com · 2022-11-29

**B.VEO TRACK****oktalite**

LED Luminous Flux Class	Light colour	CRI R _a	system luminous flux*	System performance	max. luminaires B16	Order number		
						white	silver	black
2000 lm	2700 K	81	1690 lm	13 W	27	10250503	10250504	10250505
	3000 K	83	1765 lm	13 W	27	10250506	10250507	10250508
	3000 K - Efficient White	94	1900 lm	17 W	27	10250509	10250510	10250511
	3000 K - Brilliant Colour	97	1785 lm	21 W	27	10250512	10250513	10250514
	3500 K	84	1800 lm	13 W	27	10250515	10250516	10250517
	4000 K	83	1835 lm	13 W	27	10250518	10250519	10250520
	4000 K - Efficient Cool	91	2045 lm	17 W	27	10250521	10250522	10250523
3000 lm	2700 K	81	2685 lm	23 W	27	10187197	10187198	10187199
	3000 K	83	2800 lm	23 W	27	10187200	10187201	10187202
	3000 K - Efficient White	94	2755 lm	27 W	27	10187203	10187204	10187205
	3000 K - Brilliant Colour	97	2645 lm	35 W	27	10187206	10187207	10187208
	3500 K	84	2855 lm	23 W	27	10187209	10187210	10187211
	4000 K	83	2910 lm	23 W	27	10187212	10187213	10187214
	4000 K - Efficient Cool	91	2940 lm	27 W	27	10250689	10250690	10250691
4000 lm	2700 K	81	3390 lm	31 W	27	10187215	10187216	10187217
	3000 K	83	3530 lm	31 W	27	10187218	10187219	10187220
	3000 K - Efficient White	94	3485 lm	37 W	27	10250525	10250526	10250527
	3500 K	84	3600 lm	31 W	27	10187221	10187222	10187223
	4000 K	83	3670 lm	31 W	27	10187224	10187225	10187226
	4000 K - Efficient Cool	91	3725 lm	37 W	27	10249746	10249747	10249748
3000 lm	BF	98	2500 lm	31 W	27	10250528	10250529	10250530

Accessories	Order number
Suction lifter	10206417

Technical details as well as weight specifications and measurements have been prepared with care. Errors excepted. All dimensions in mm · LED service life data: L80/B10 at ambient temperature (ta) 25°C. Rated lamp service life 50,000h. Luminous flux and efficiency specifications are subject to a tolerance of +/- 10%. Min CRI Ra: >80 / >90 · Product images are used as an example and may differ from the original · We reserve the right to make changes, insofar as they serve progress. The Single Lighting Regulation (SLR) documentation can be found in our download area. Oktalite Lichttechnik GmbH · Mathias-Brüggen-Str. 73 · 50829 Cologne · T 49 221 59767-0 · F 49 221 59767-40 · mail@oktalite.com · www.oktalite.com · 2022-11-29

* System luminous flux based on medium flood reflector.



Efficient White: $R_9 = 75$, $R_r = 91$, $R_g = 102$



Brilliant Colour: $R_9 = 94$, $R_r = 95$, $R_g = 104$

Technical details as well as weight specifications and measurements have been prepared with care. Errors excepted. All dimensions in mm · LED service life data: L80/B10 at ambient temperature (t_a) 25°C. Rated lamp service life 50,000h. Luminous flux and efficiency specifications are subject to a tolerance of $\pm 10\%$. Min CRI Ra: >80 / >90 · Product images are used as an example and may differ from the original · We reserve the right to make changes, insofar as they serve progress. The Single Lighting Regulation (SLR) documentation can be found in our download area. Oktalite Lichttechnik GmbH · Mathias-Brüggen-Str. 73 · 50829 Cologne · T 49 221 59767-0 · F 49 221 59767-40 · mail@oktalite.com · www.oktalite.com · 2022-11-29

Optic 85 - LED

oktalite

Optic 3D faceted reflectors
 Type interchangeable reflector system

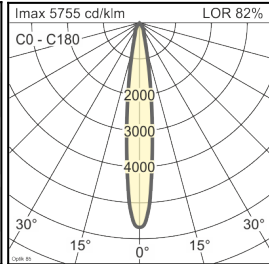
Beam angle				Cover	LOR	Order number																							
Spot						white	silver	black																					
Optik 85 - SP <table border="1"> <thead> <tr> <th>Höhe [m]</th> <th>KegelØ [cm]</th> <th>E(0°) [lx/klm]</th> <th>E(C0) [lx/klm]</th> </tr> </thead> <tbody> <tr> <td>1</td> <td>26</td> <td>5755</td> <td>2841</td> </tr> <tr> <td>2</td> <td>52</td> <td>1439</td> <td>710</td> </tr> <tr> <td>3</td> <td>78</td> <td>639</td> <td>316</td> </tr> </tbody> </table>				Höhe [m]	KegelØ [cm]	E(0°) [lx/klm]	E(C0) [lx/klm]	1	26	5755	2841	2	52	1439	710	3	78	639	316						without	82 %	-	-	10183944
Höhe [m]	KegelØ [cm]	E(0°) [lx/klm]	E(C0) [lx/klm]																										
1	26	5755	2841																										
2	52	1439	710																										
3	78	639	316																										
				clear	78 %	-	-		10184576																				

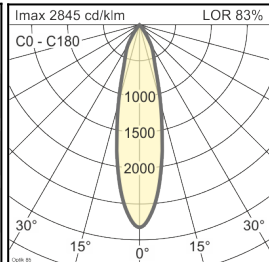
Beam angle				Cover	LOR	Order number																							
Medium Flood						white	silver	black																					
Optik 85 - MF <table border="1"> <thead> <tr> <th>Höhe [m]</th> <th>KegelØ [cm]</th> <th>E(0°) [lx/klm]</th> <th>E(C0) [lx/klm]</th> </tr> </thead> <tbody> <tr> <td>1</td> <td>45</td> <td>2845</td> <td>1321</td> </tr> <tr> <td>2</td> <td>91</td> <td>711</td> <td>330</td> </tr> <tr> <td>3</td> <td>136</td> <td>316</td> <td>147</td> </tr> </tbody> </table>				Höhe [m]	KegelØ [cm]	E(0°) [lx/klm]	E(C0) [lx/klm]	1	45	2845	1321	2	91	711	330	3	136	316	147						without	83 %	-	-	10183959
Höhe [m]	KegelØ [cm]	E(0°) [lx/klm]	E(C0) [lx/klm]																										
1	45	2845	1321																										
2	91	711	330																										
3	136	316	147																										
				clear	79 %	-	-		10184577																				

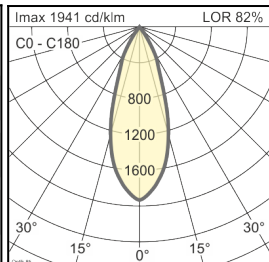
Beam angle				Cover	LOR	Order number																							
Flood						white	silver	black																					
Optik 85 - FL <table border="1"> <thead> <tr> <th>Höhe [m]</th> <th>KegelØ [cm]</th> <th>E(0°) [lx/klm]</th> <th>E(C0) [lx/klm]</th> </tr> </thead> <tbody> <tr> <td>1</td> <td>66</td> <td>1941</td> <td>832</td> </tr> <tr> <td>2</td> <td>132</td> <td>485</td> <td>208</td> </tr> <tr> <td>3</td> <td>197</td> <td>216</td> <td>92</td> </tr> </tbody> </table>				Höhe [m]	KegelØ [cm]	E(0°) [lx/klm]	E(C0) [lx/klm]	1	66	1941	832	2	132	485	208	3	197	216	92						without	82 %	-	-	10183953
Höhe [m]	KegelØ [cm]	E(0°) [lx/klm]	E(C0) [lx/klm]																										
1	66	1941	832																										
2	132	485	208																										
3	197	216	92																										
				clear	78 %	-	-		10184578																				

Technical details as well as weight specifications and measurements have been prepared with care. Errors excepted. All dimensions in mm · LED service life data: L80/B10 at ambient temperature (ta) 25°C. Rated lamp service life 50,000h. Luminous flux and efficiency specifications are subject to a tolerance of +/- 10%. Min CRI Ra: >80 / >90 · Product images are used as an example and may differ from the original · We reserve the right to make changes, insofar as they serve progress. The Single Lighting Regulation (SLR) documentation can be found in our download area. Oktalite Lichttechnik GmbH · Mathias-Brüggen-Str. 73 · 50829 Cologne · T 49 221 59767-0 · F 49 221 59767-40 · mail@oktalite.com · www.oktalite.com · 2022-11-29

Optic 85 - LED

oktalite

Optic 3D faceted reflectors
 Type interchangeable reflector system

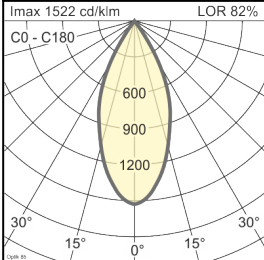
Beam angle				Cover	LOR	Order number																							
Wide Flood						white	silver	black																					
Optik 85 - WFL <table border="1"> <thead> <tr> <th>Höhe [m]</th> <th>KegelØ [cm]</th> <th>E(0°) [lx/klm]</th> <th>E(C0) [lx/klm]</th> </tr> </thead> <tbody> <tr> <td>1</td> <td>83</td> <td>1522</td> <td>601</td> </tr> <tr> <td>2</td> <td>167</td> <td>381</td> <td>150</td> </tr> <tr> <td>3</td> <td>250</td> <td>169</td> <td>67</td> </tr> </tbody> </table>				Höhe [m]	KegelØ [cm]	E(0°) [lx/klm]	E(C0) [lx/klm]	1	83	1522	601	2	167	381	150	3	250	169	67						without	82 %	-	-	10183954
Höhe [m]	KegelØ [cm]	E(0°) [lx/klm]	E(C0) [lx/klm]																										
1	83	1522	601																										
2	167	381	150																										
3	250	169	67																										
				clear	78 %	-	-		10184579																				

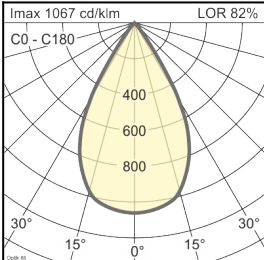
Beam angle				Cover	LOR	Order number																							
Very Wide Flood						white	silver	black																					
Optik 85 - VFL <table border="1"> <thead> <tr> <th>Höhe [m]</th> <th>KegelØ [cm]</th> <th>E(0°) [lx/klm]</th> <th>E(C0) [lx/klm]</th> </tr> </thead> <tbody> <tr> <td>1</td> <td>111</td> <td>1067</td> <td>360</td> </tr> <tr> <td>2</td> <td>223</td> <td>267</td> <td>90</td> </tr> <tr> <td>3</td> <td>334</td> <td>119</td> <td>40</td> </tr> </tbody> </table>				Höhe [m]	KegelØ [cm]	E(0°) [lx/klm]	E(C0) [lx/klm]	1	111	1067	360	2	223	267	90	3	334	119	40						without	82 %	-	-	10183955
Höhe [m]	KegelØ [cm]	E(0°) [lx/klm]	E(C0) [lx/klm]																										
1	111	1067	360																										
2	223	267	90																										
3	334	119	40																										
				clear	78 %	-	-		10184580																				

Technical details as well as weight specifications and measurements have been prepared with care. Errors excepted. All dimensions in mm · LED service life data: L80/B10 at ambient temperature (ta) 25°C. Rated lamp service life 50,000h. Luminous flux and efficiency specifications are subject to a tolerance of +/- 10%. Min CRI Ra: >80 / >90· Product images are used as an example and may differ from the original · We reserve the right to make changes, insofar as they serve progress. The Single Lighting Regulation (SLR) documentation can be found in our download area. Oktalite Lichttechnik GmbH · Mathias-Brüggen-Str. 73 · 50829 Cologne · T 49 221 59767-0 · F 49 221 59767-40 · mail@oktalite.com · www.oktalite.com · 2022-11-29